



Neighbourhood Zone 4

- Legend**
- Red line site boundary
  - SOFT LANDSCAPE
  - Existing trees, hedgerow and water courses to be retained and protected (Refer to Landscape and Arbolocultural reports)
  - Proposed Trees, Multi-Stem Trees and Ornamental Shrubs including: Street trees: Downy Birch, Maidenhair Tree, Sweetgum, Ornamental Pear, etc. Rain Garden trees: Alder, Birch, Spanish Oak, etc. Parkland trees: Oak, Horse Chestnut, Beech, Aspen, Cherry Tree, Rowan, Whitebeam, etc. Fruit Trees: Pear tree, Apple tree, Plum and Cherry. Boundary Screening trees: Holly, Hawthorn, Blackthorn, Silver Birch, Oak. Ornamental Shrubs: Hydrangea, Hawthorn, Elder, Myrtle, Common Juniper. (Refer to planting schedule)
  - Native Boundary Woodland mix (Height 2L 90-100 cm Ht): *Crataegus monogyna*\*\*, *Prunus spinosa*\*\*, *Ilex aquifolium*\*\*, *Rosa canina*\*\*
  - Ornamental Planting Mix 150mm topsoil depth: Mix of ornamental grasses to provide all year round flow and texture in planting beds, including: Coneflowers, Sea Holly, Foxgloves, Russian Sage, Golden Oats, Tufted Hair Grasses, Terracotta Yarrow, etc.
  - Rain Gardens Planting Mix Ornamental adapted planting mix, including: Yellow Yris, Chinese Silver grass, Adderwort, Gold Dew tufted Hair Grass, Reed grasses, etc.
  - Amenity Grass Areas 150mm topsoil depth
  - Native Ecological Habitat Seed Mix These mixtures contain 70% grasses with 30% long lasting perennial wildflowers. They are specifically designed for habitat restoration projects with the aim of providing maximum benefit to biodiversity. Each mix contains over 15 native species.
  - Wetland Wildflower (Seasonally Flooded) These mixtures has been specially selected to establish a native wildflower meadow on soils that remain damp year round and may experience some flooding such as a pond edge. Each mix contains over 22 native species.

- SUDS**
- Bio-retention Area / Detention Basin Designed for water management while providing aesthetic appeal. Species in these areas are capable of withstanding floods and excess while also attracting pollinators to promote biodiversity. This mix inc: Meadowweet, *Filipendula ulmaria*, Flag Iris, *Iris pseudacorus*, Ma Margoli, *Galium palustre*, Purple Loosestrife, *Lythrum salicaria*, *Bc Eriophorum angustifolium*, Water Mint, *Mentha aquatica*
  - Rain Gardens / Bioretention Rain Gardens Functional solution for stormwater attenuation to engineers specifications
  - Swale Refer to engineers detail drawings
- HARD LANDSCAPING**
- Asphalt Roadway with in-situ concrete kerbs (to Engineer's specification)
  - Car Parking Spaces Permeable paving
  - HomeZone & Raised Table Permeable paving / Coloured asphalt
  - Cycleway Coloured Asphalt
  - Public Footpaths In-situ concrete, Brushed Finish, concrete slabs
  - Footpaths - Main Parks Buffed colour asphalt
  - Bio-retention Park - Running Track Coloured asphalt with white painting
  - Asphalt footpaths With painting where indicated
  - Paving - Entrance to Houses and Communal Open Spaces Permeable block paving
  - Safety Surface - Playground / Fitness Engineered woodchip
- Safety Grass Matting** Playground / Fitness safety surface
- Ecological Walkway observatory / Steel Bridge** Steel mesh panel platform bridge
- Grasscrete** Concrete grass
- Furniture and Features**
- Fitness/ Play Equipment supplied by Kompan.com (Refer to Landscape Design Rationale)
  - s71 Cycle Stand supplied by Omos.ie
  - Feature Seating Elements Bespoke timber seats Selected seating elements
  - s59.2se Seat supplied by Omos.ie
  - s86w Picnic Set supplied by Omos.ie
  - Communal / Private Bins Storage As per architecture details
  - Communal / Private Bike Storage As per architecture details
  - Lighting Refer to lighting plan and report



Neighbourhood Zone 1

Reference Images

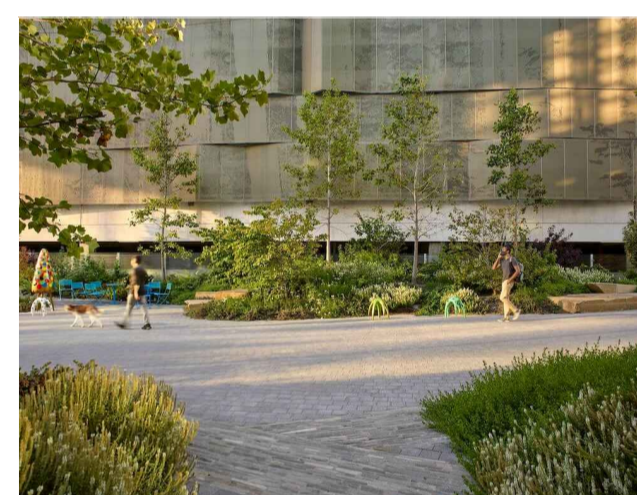

g+a Landscape Architecture

+353 84 128 1923 + info@gannondassociates.ie + gannondassociates.ie  
+Terenure Enterprise Centre, 17 Rathfarnham Rd, Terenure, Dublin, D6W X921

REV	DATE	REVISION	DRAWN	CHECKED
E	14/08/2024	Issued for Planning	AP	JG
D	12/08/2024	Issued for Comments	AP	JG
C	07/12/2023	Issued for Planning stage 1	AP	JG
B	04/12	Issued for discussion	AP	JG
A	21/11	Issued for discussion	AP	JG

CLIENT  
CAPAMI LTD  
PROJECT TITLE  
Oldcourt Proposed Development, Oldcourt road, Ballycullen, Co. Dublin  
PROJECT ARCHITECT  
Davey + Smith Architecture  
SHEET TITLE  
Landscape Detail Area 3  
SHEET NO.  
23130\_LP\_DT03  
SHEET SIZE  
A1  
SCALE  
1:500  
REVISION  
E  
DATE  
Aug 2024  
STAGE  
Planning Application  
Copyright Gannond Associates, 2024